

TERITORIU ADMINISTRATIV : BREAZA (intravilan)
 Adresa: oras Breaza, loc. Podu Corbului, str. Mesteacanului, nr. 22C, Tarlăua 23, Parcela AL1938, jud. Prahova.
 Proprietari: POPA PETRE din oras Ploiesti, str. Mierlei, nr. 33, jud. Prahova.
 POPA LUMINITA-ELENA din oras Ploiesti, str. Mierlei, nr. 33, jud. Prahova.
 Act de proprietate: Act notarial nr. 477 din 25.02.2021.
 Certificat de urbanism nr. _____
 Extras de carte funciara pentru informare nr. 9882 din 02.02.2023.
 Corpul de proprietate are NR. CAD. 28283.
 Suprafata teren măsurat S=2014,00 mp. (din acte, S=2014.00 mp).

R.N.1
 REPER NIVELMENT

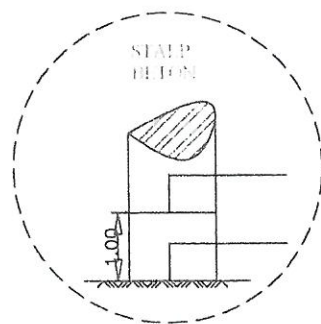

R.N.2
 REPER NIVELMENT

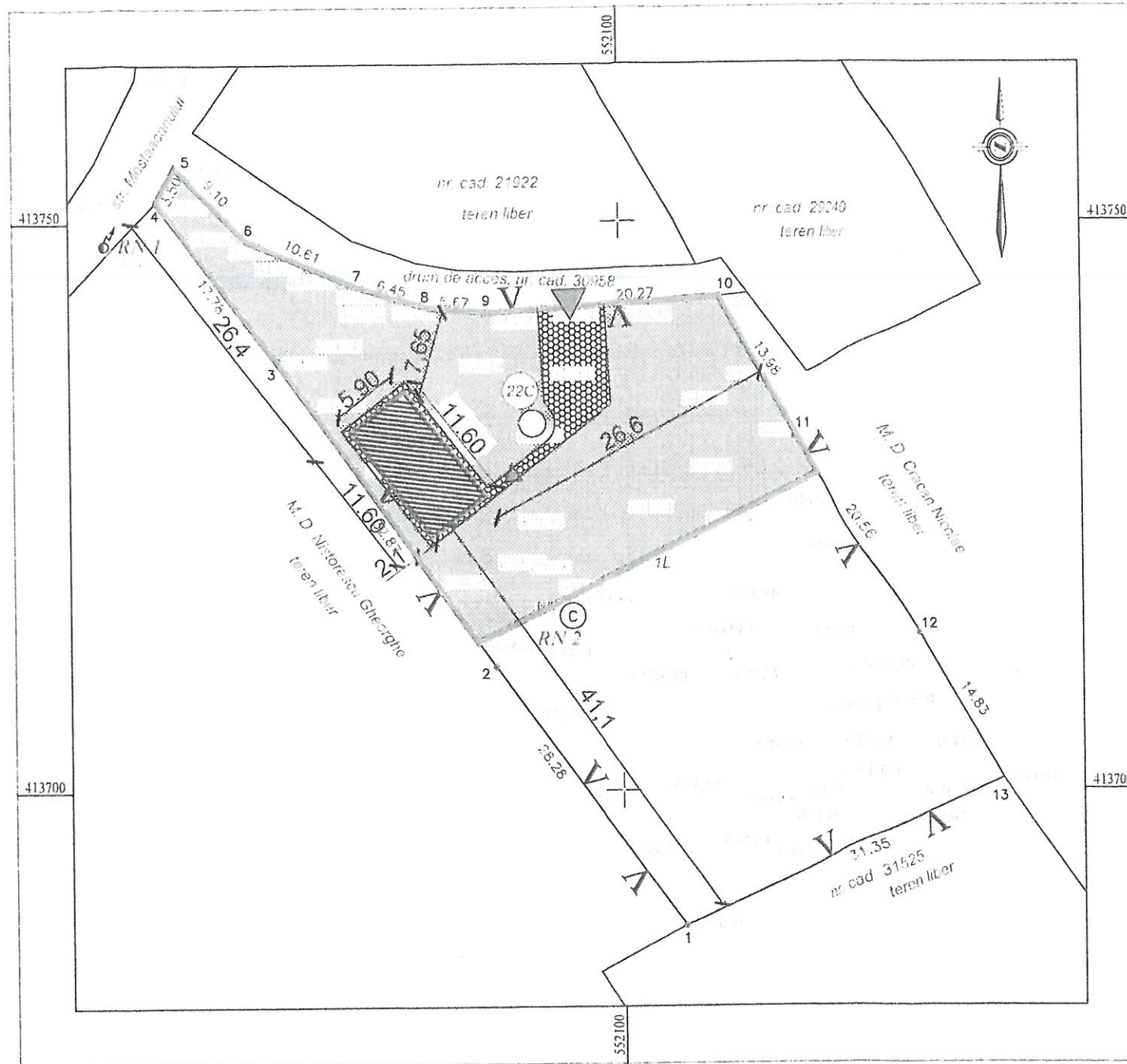
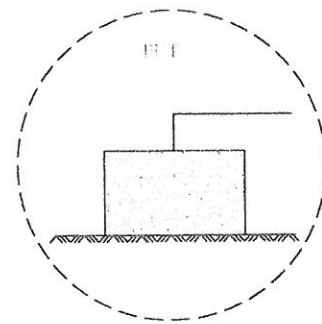



LEGENDA:

-Constructie propusa
 -Acces
 -Contur curte-1000 mp

-spatiu verde-gazon
 -pavaj-parcare si trotuare

GARD PLASA DE SARIA
 GARD LEHN
 GARD BETON
 GARD METAL
 CONDUCTA GAZ
 CONDUCTA APA
 CAMIN VENTILE
 CAMIN CANALIZARE
 REPER DE NIVELMENT
 PUNCT COTAT

ORDINUL ARHITECTILOR
 DIN ROMANIA
 2370
 Teodor
 GRIGORITA
 Arhitect cu drept de semnatura

| | | | | | | | |
|-------------------------------------|-----------------------|---|---|---|------------------------------|--|--|
| | | | | Referat expertiza nr./Data | | | |
| Verificator / Expert | ing. Aron DIENES | | | | | | |
| SC GRAPHIC DESIGN SRL | | | | Beneficiar: POPA PETRE | Proiect nr: 40/202 | | |
| str. Mesteacanului nr. 4, Baia Mare | | | | Adresa amplasament: JAT BREAZA, loc. Podul Corbului, str. Mesteacanului nr. 22C jud. Prahova | | | |
| CUI 24048375 | | | | | | | |
| Sef proiect | arh. Teodor GRIGORITA |  | Scara: 1:1000 | Denumire plansa: PLAN DE SITUATIE | Faza: D.T.A. | | |
| Proiectat arhitectura | c.arh. Mircea TOHATAN | |  | | | | |
| Proiectat rezistenta | ing. Ionica ROMOCEA | | | | | | |
| Desenat | c.arh. Mircea TOHATAN | | | | | | |
| | | | | 01.06.2023 | | | |
| | | | | Denumire proiect: CONSTRUIRE LOCUINTA PARTER SI BRANSAMENT ELECTRIC | Pl. nr.: | | |